

## FLOAT AND THERMOSTATIC STEAM TRAPS FLT 17 ( DN 40 - 50 )

### DESCRIPTION

FLT 17 float and thermostatic (integral air vent) steam traps series are designed for all types of low and medium pressure steam heating and process equipment.

Connections are female screwed or flanged for horizontal or vertical installation.

### MAIN FEATURES

Modulating discharge.

Discharges condensate at steam temperature.

Unaffected by sudden or wide load and pressure changes.

Excellent air discharge (by thermostatic air vent).

**OPTIONS:** Equalizing plug ,venting connection and drain plug ( or blow-off valve on cover).

**USE :** Saturated and superheated steam.

### AVAILABLE

**MODELS :** FLT 17-4.5 - FLT 17-10 - FLT 17-14.

**SIZES :** 1 1/2", 2" - DN40, DN50.

**CONNECTIONS :** Female screwed ISO 7/1 Rp (BS21)  
Flanged DIN. Special flanges upon request.

**INSTALLATION :** Standard horizontal installation -  
flow from right to left FLT16 (R-L)

Upon request:

-horizontal installation with the flow from left to right FLT17 (L-R)

-vertical installation with the flow from top to bottom FLT17 (V)

See IMI, installation and maintenance instructions.

PMA :Max.allowable pressure 16 bar

TMA: Max.allowable temperature 250 °C

PMO: Max.operating pressure 14 bar

TMO: Max.operating temperature 198 °C

How to order: i.e. FLT17-10 DN 40 DIN

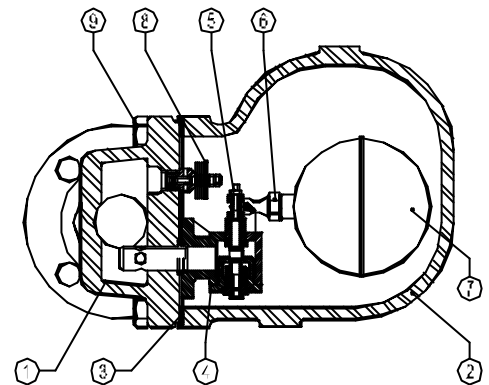

### MATERIALS:

POS.NR.	DESIGNATION	MATERIAL
1	BODY	GGG40
2	COVER	GGG40
3 *	GASKET	NON ASBESTOS
4 *	SEAT	AISI 410
5 *	VALVE	AISI 410
6 *	LEVER	AISI 304
7 *	FLOAT	AISI 304
8 *	AIR VENT	STAINLESS STEEL
9	BOLTS	STEEL 8.8

\* AVAILABLE SPARE PARTS

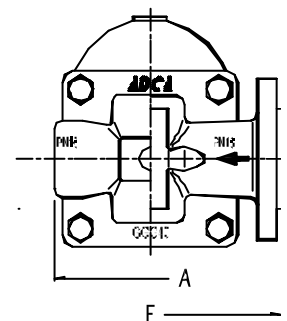
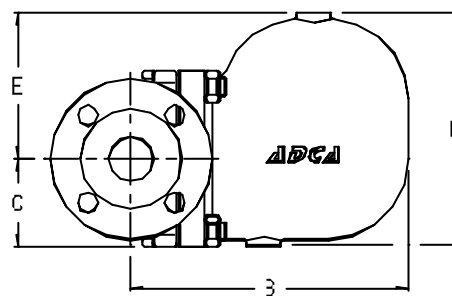

Max.differential pressure

FLT 17-4.5 - 4.5 bar

FLT 17 -10 - 10 bar

FLT 17- 14 - 14 bar

### DIMENSIONS (mm)

SIZE	SCREWED ENDS					WEIGHT Kg	DIN FLANGES		
	A	B	C	D	E		F	B	WEIGHT Kg
DN									
40	210	248	79	208	131	16,9	230	248	20,3
50	210	248	79	208	131	17,5	230	248	22,2

### FLOW RATE CAPACITY IN Kg/h

MODEL	SIZE	DIFFERENTIAL PRESSURE (bar)											
		0,1	0,3	0,5	0,7	1	1,5	2	4,5	7	10	12	14
FLT17-4,5	40-50	1100	1800	2400	2800	3400	3900	4500	7300				
FLT17- 10	40-50	650	1200	1500	1750	2000	2600	3000	4000	5400	6200		
FLT17- 14	40-50	450	750	950	1100	1300	1600	1800	2600	3250	3900	4210	4950

Recommended safety factor : continuous 1.2 - 1.5 ; discontinuous flow 2 - 3 .