

## SIGHT CHECKER SCK

### DESCRIPTION

Being installed after the steam trap, the sight checker is a device to be used for visually checking the conditions and leakage of steam traps.

SCK sight checker functions as both sight glass and check valve.

Connections are female screwed.

USE: Condensate pipes downstream steam traps.

### AVAILABLE MODELS:

SCK

SIZES: 1/2", 3/4" and DN 1"

CONNECTIONS: Female screwed ISO 7/1Rp(BS21).

INSTALLATION: Horizontal or vertical (bottom to top) installation.

See IMI, installation and maintenance instructions.

CAUTION: SCK should be fitted at least 1m from the trap to protect the glass from thermal pressure or shock.

PMO:Max.operating pressure 10 bar

TMO:Max.operating temperature 150 °C

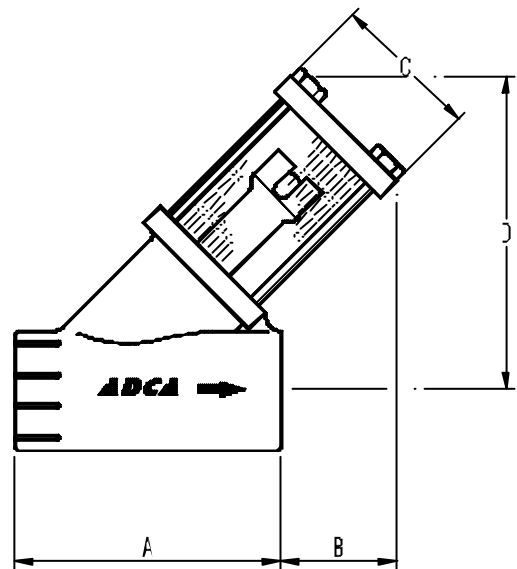
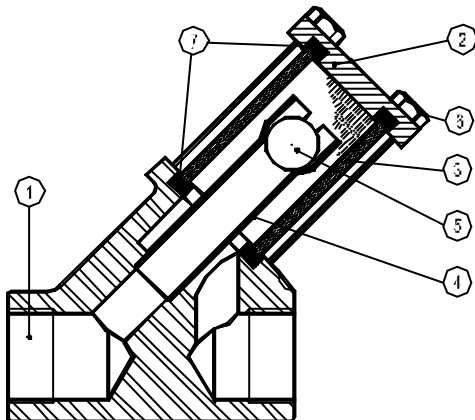
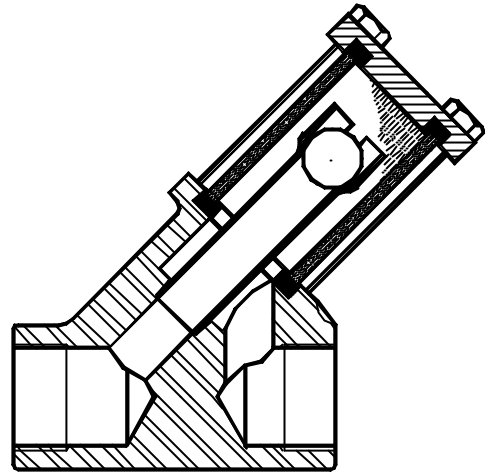

How to order: i.e. SCK DN 1/2" BSP

### MATERIALS

POS. NR	DESIGNATION	MATERIAL
1	BODY	BRONZE
2	COVER	BRASS
3 *	SIGHT TUBE	BOROSILICATE GLASS
4	DISCHARGE TUBE	COPPER
5	BALL CHECK	STAINLESS STEEL
6	BOLTS	STEEL PLATED
7 *	GASKET	GRAPHITE

\* AVAILABLE SPARE PARTS

DIMENSIONS (mm)					
SIZE	A	B	C	D	WEIGHT
DN	Kg				
1/2"	80	36	45	95	0,9
3/4"	80	36	45	95	0,9
1"	90	40	56	110	1,3