

SEPARATORS

S 25

DESCRIPTION

S-25 series centrifugal separators remove moisture from steam and compressed air pipelines. Steam and compressed air passing through the separator and as a result of centrifugal forces, impact and swirling effects, separate the particles with a heavier specific gravity, such as water and oil droplets, moisture in suspension, dirt and scale.

The condensate collected at the bottom of the separator, must be automatically drained by a suitable steam or compressed air trap.

Connections are female screwed or flanged.

MAIN FEATURES

Several possibilities of installation.

No moving parts.

OPTIONS: Zinc plated fabricated carbon steel construction (compressed air).
Stainless steel construction.
Condensate flanged connection.
Air vent or equalizing socket on top.

USE: Steam, compressed air and other gases (Group 2).

AVAILABLE MODELS: S25/S - carbon steel body.
S25/SZ - zinc plated body.

SIZES: Screwed: DN½" to DN2".
Flanged: DN15 to DN200.
Different sizes and design on request.

CONNECTIONS: Female screwed ISO 7/1Rp(BS21)
Flanged DIN PN 16 and PN 40 or ANSI Class 150 and Class 300 lbs.

INSTALLATION: Always with the condensate discharge pointing downwards.
See IMI, installation and maintenance instructions.

HOW TO SELECT: Generally, in an existing plant it is advisable to fit a separator of the same size of the pipe line. Pressure drop is normally negligible. For approximate pressure drop calculation please consult.

How to order: i.e. S25/S DN 40 PN16

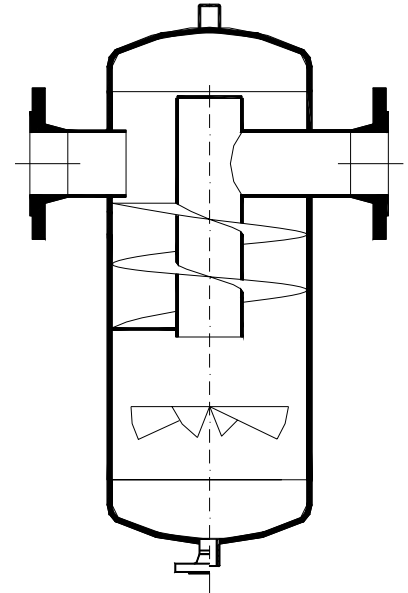

APPLICATION LIMITS / CE MARKING

SIZE	DN15	DN20	DN25	DN32	DN40	DN50
RATING	PN16	PN16	PN16	PN16	PN16	PN16
APPROVAL	SEP	SEP	SEP	CE	CE	CE
RATING	PN40	PN40	PN40	PN40	PN40	PN40
APPROVAL	CE	CE	CE	CE	CE	CE

SIZE	DN65	DN80	DN100	DN125	DN150	DN200
RATING	PN16	PN16	PN16	PN16	PN16	PN16
APPROV.	CE	CE	CE	CE	CE	CE
RATING	PN40	PN40	PN40	PN40	PN40	PN25
APPROV.	CE	CE	CE	CE	CE	CE

CE: Marked.

LIMITING CONDITIONS

	PRESS. bar	TEMP. °C
DIN PN16	16	120
	a) 14	198
	13	250
ANSI CL.150	16	120
	a) 14	198
DIN PN 25 ANSI CL. 300	25	120
	a) 21	220
	17	300
DIN PN 40 ANSI CL.300	40	120
	a) 32	239
	28	300

a) PMO - Maximum operating pressure for saturated steam.

Minimum operating temperature: -10°C
Design code: AD-Merkblatt (2000).

GROUP 2 GASES CATEGORIES

RATING	SIZES DN	Category
DIN PN 16	15 - 25	SEP
	32 - 50	1
	65 - 125	2
	150 - 200	3
DIN PN 25	200	3
DIN PN 40	15 - 32	1
	40 - 80	2
	100 - 150	3

CE Marking :

This product have been designed for use on water, steam, air and other gases wich are in Group 2 of the PED-European Pressure Equipment Directive 97/23/EC and it comply with those requirements. The product carry the CE mark when falling in category 1 and above.

APPROXIMATE DIMENSIONS (mm)

SIZE DN	PN 16 DIN FLANGES						VOL* dm3	WGT** Kg	Screwed Ends		DIN FL.	ANSI FLANGES	
	A	B	C	D	E	F			G	WGH Kg	A PN 40	A 150 lbs	A 300 lbs
15	230	114	260	195	60	½"	2	5	160	4,3	230	Consult factory	
20	230	114	260	195	65	½"	2,5	6	160	4,4	230		
25	230	114	300	200	90	½"	3	7	160	5,3	230		
32	260	140	395	294	100	½"	5	12	190	8,2	260		
40	260	140	435	335	105	½"	5,7	13,8	190	9,2	260		
50	310	168	505	395	120	½"	10,5	19,5	220	15,1	310		
65	380	219	550	410	140	¾"	18,5	32	—	—	394		
80	400	219	610	462	148	¾"	25	37,7	—	—	416		
100	485	273	715	528	187	¾"	35,4	57	—	—	510		
125	535	324	845	630	215	1"	50	81,5	—	—	555		
150	585	356	962	780	270	1"	75	153	—	—	585		
200	605	406	1170	880	290	1"	95	175	—	—	650		

* Volume correspond to the class PN16 design. Classes PN 25 and PN 40 may have slightly lower volumes.

** Weight correspond to the class PN16 design flanged with DIN flanges .

F - Screwed drain connection as standard . Alternatively can be supplied flanged DIN or ANSI on the same class of main connections.

Air vent or balancing pipe connection on top can be supplied on request , not exceeding the size of drain one .

Note: Dimensions subject to change without notice. Consult factory for certified dimensions.

Other sizes and designs can be supplied under request.

RATING	SEPARATOR SIZE	FLANGE DIN STD.	FLANGE ANSI STD.
PN16	* From DN 15 to DN 50	DIN 2635 - PN40	ANSI B16.5 - CL. 150 lbs
PN16	DN 65 and above	DIN 2633 - PN16	ANSI B16.5 - CL. 150 lbs
PN25	ALL	DIN 2635 - PN40	ANSI B16.5 - CL. 300 lbs
PN40	ALL	DIN 2635 - PN40	ANSI B16.5 - CL. 300 lbs

* Flanges DIN 2633 and DIN 2635 on the sizes DN 15 up to DN 50 has the same number and size holes.

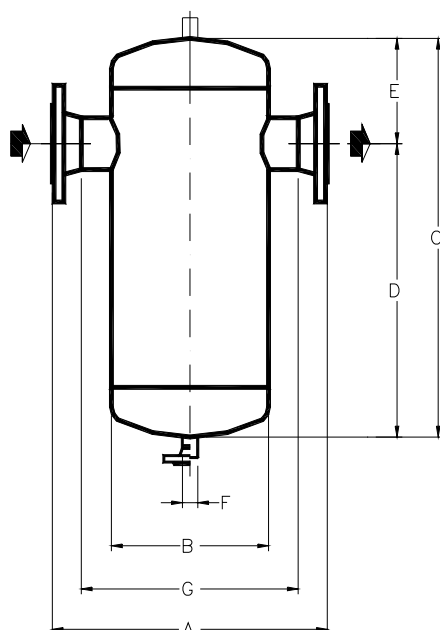
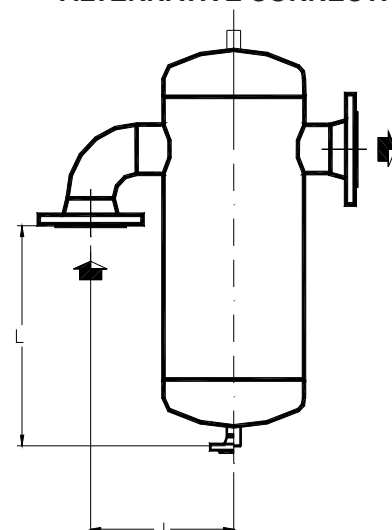
INLINE CONNECTIONS

ALTERNATIVE CONNECTION

EVH - ELBOW VERTICAL INLET / HORIZONTAL OUTLET

DESCRIPTION	MATERIAL	
Body	Carbon steel	DIN 17175 / St 35.8
Heads	Carbon steel	EN 10028/2 / P265GH
Inlet/Outlet pipes	Carbon steel	DIN 17175 / St 35.8
DIN flanges	Carbon steel	DIN 17243 / C 22.8
ANSI flanges	Carbon steel	ASTM A 105
Sockets	Carbon steel	ASTM A 105
Internals	Steel	St 37-2 / St 35.8