



INSTALLATION AND MAINTENANCE INSTRUCTIONS PRESSURE REDUCING VALVES (PRV25S - PRV25SS - PRW25SS)

GENERAL

1. These instructions must be carefully read before any work involving products supplied by VALSTEAM ADCA ENGINEERING S.A. is undertaken.

2. The installation procedure is a critical stage in a life of a valve and care should be taken to avoid damage to the valve or equipment. Reducing valves are designed to give accurate control of down-stream pressures. They give their maximum performance only when the equipment associated with them is correctly sized and installed in accordance with our recommendations.

Warning !

-If malfunction of any other equipment or system operation failure may result in a dangerous overpressure, overtemperature or even vacuum condition, a safety device must be included in the system to prevent such situations.

-At start up, the presence of small particles in the fluid (dirt, scale, weld splatters, etc) may cause an unperfect closure of the seat. If this occur, proceed to an accurate cleaning.

-Do not touch the equipment without appropriate protection during working operation because it may conduct heat if the used fluid is at high temperature.

-Before starting maintenance be sure that the equipment is not pressurized or hot.

-The equipments must be used within the working temperature and pressure limits laid down for them, otherwise they may fail (refer to nameplate and/or IS- Information Sheet).

-Do not remove the nameplate attached to the equipment. Serial number and other useful information is stamped on it.

INSTALLATION

1. Prior to install check that the product is suitable for the intended application: materials and pressure/temperature ratings.

2. Before to install remove plastic covers placed on flanges or connection ends. The equipment has an arrow or Inlet/Outlet designations. Be sure that it will be installed on the appropriate direction.

3. Take care with jointing material to ensure that none may be permitted to block or enter the valve.

4. Reducing valves are recommended to be fitted with the centre line of the valve in a vertical position to ensure that the best results are obtained.

5. An ADCA pipeline strainer should be installed upstream of the valve to protect from dirt which could damage the valve or cause mal-functioning.

6. The reducing valve pipework should be properly supported and free from strain and it should not be subjected to undue surges of pressure.

For steam installations we strongly recommend that the reducing valve is positioned where condensation is unable to collect or that, alternatively, separators and steam traps are fitted so that the pipework drains correctly. The start up condition should be considered.

MAINTENANCE

1. We recommend that the pressure reducing valves are serviced as necessary. Pressure reducing valves should be checked periodically (at least yearly), to verify that they are operating correctly and to clean the internal parts and screen (if any).

2. When reassembling make sure that all gasket faces are clean and always use a new gasket. Tighten cover bolts uniformly in a diagonal sequence.

3. Valves in store for long periods should have their adjusting spring relaxed.

4. For further information refer to the relevant PRV brochure or consult our Sales Office.

LIMITING CONDITIONS PRV 25:

Body design conditions : PN 25

Maximum upstream pressure : 17 bar

Maximum downstream pressure : 8,6 bar

Minimum downstream pressure : 0,14 bar

Maximum design temperature : 210°C

Maximum cold hydraulic test : 38 bar

Maximum reducing ratio : 10:1

LIMITING CONDITIONS PRW 25:

Body design conditions : PN 25

Maximum upstream pressure : 14 bar

Maximum downstream pressure : 8,6 bar

Minimum downstream pressure : 0,35 bar

Maximum design temperature : 75°C

Maximum cold hydraulic test : 38 bar

Maximum reducing ratio : 10:1

CE Marking :

This product has been designed for use on steam, air and other gases which are in Group 2 of the PED-European Pressure Equipment Directive 97/23/EC and it complies with those requirements.

The product falls within category SEP and must not be CE marked.

LOSS OF GUARANTEE : Total or partial disregard of above instructions involves loss of any right to guarantee.

PARTS LIST FOR PRV25S PRESSURE REDUCING VALVES:

Code	Designation	Valve size	Pos.Nr.	Qty.
VR.9210.015	Bellows& body gasket	DN1/2"-1"	14,15	1set
VR.9210.115	Spring&body gasket (0,14-1,7bar)	DN1/2"-1"	15,16,21	1set
VR.9210.215	Spring&body gasket (1,4 - 4bar)	DN1/2"-1"	15,16,21	1set
VR.9210.315	Spring&body gasket (3,5 - 8,6bar)	DN1/2"-1"	15,16,21	1set
VR.9213.015	Seat & plug package	DN1/2"	3,4,5,6,7,10	1set
VR.9213.020	Seat & plug package	DN3/4"	3,4,5,6,7,10	1set
VR.9213.025	Seat & plug package	DN1"	3,4,5,6,7,10	1set

Recommended tightening torques for PRV25S :

Pos.Nr.	Size	Nm
3	1/2"-1"	100-110
9	1/2"-1"	65-75
11	1/2"-1"	20-25

Remarks: Tighten cover bolts uniformly.

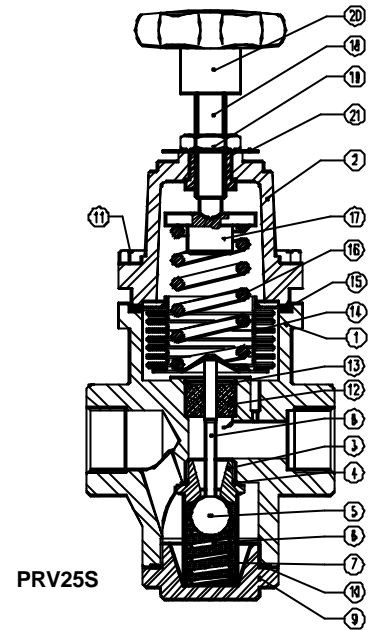
PARTS LIST FOR PRV25SS PRESSURE REDUCING VALVES:

Code	Designation	Valve size	Pos.Nr.	Qty.
VR.9232.015	Bellows& body gasket	DN1/2"-1"	14,15	1set
VR.9232.215	Spring&body gasket (0,14-1,7bar)	DN1/2"-1"	15,16,21	1set
VR.9232.315	Spring&body gasket (1,4 - 4bar)	DN1/2"-1"	15,16,21	1set
VR.9232.415	Spring&body gasket (3,5 - 8,6bar)	DN1/2"-1"	15,16,21	1set
VR.9233.015	Plug package	DN1/2"	5,6,7,10	1set
VR.9233.020	Plug package	DN3/4"	5,6,7,10	1set
VR.9233.025	Plug package	DN1"	5,6,7,10	1set

Recommended tightening torques for PRV25SS :

Pos.Nr.	Size	Nm
2	1/2"-1"	90-100
9	1/2"-1"	65-75

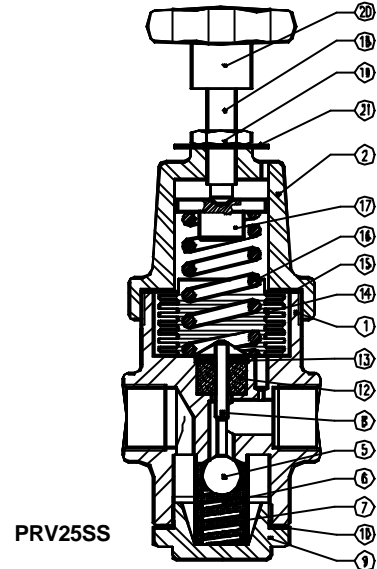
PARTS LIST FOR PRW25SS PRESSURE REDUCING VALVES:

Code	Designation	Valve size	Pos.Nr.	Qty.
VR.9232.015	Bellows& body gasket	DN1/2"-1"	14,15	1set
VR.9232.115	Spring&body gasket (0,35-1,7bar)	DN1/2"-1"	15,16,21	1set
VR.9232.315	Spring&body gasket (1,4 - 4bar)	DN1/2"-1"	15,16,21	1set
VR.9232.415	Spring&body gasket (3,5 - 8,6bar)	DN1/2"-1"	15,16,21	1set
VR.9234.015	Plug package	DN1/2"	5,6,7,10	1set
VR.9234.020	Plug package	DN3/4"	5,6,7,10	1set
VR.9234.025	Plug package	DN1"	5,6,7,10	1set

Recommended tightening torques for PRW25SS :

Pos.Nr.	Size	Nm
2	1/2"-1"	90-100
9	1/2"-1"	65-75

